

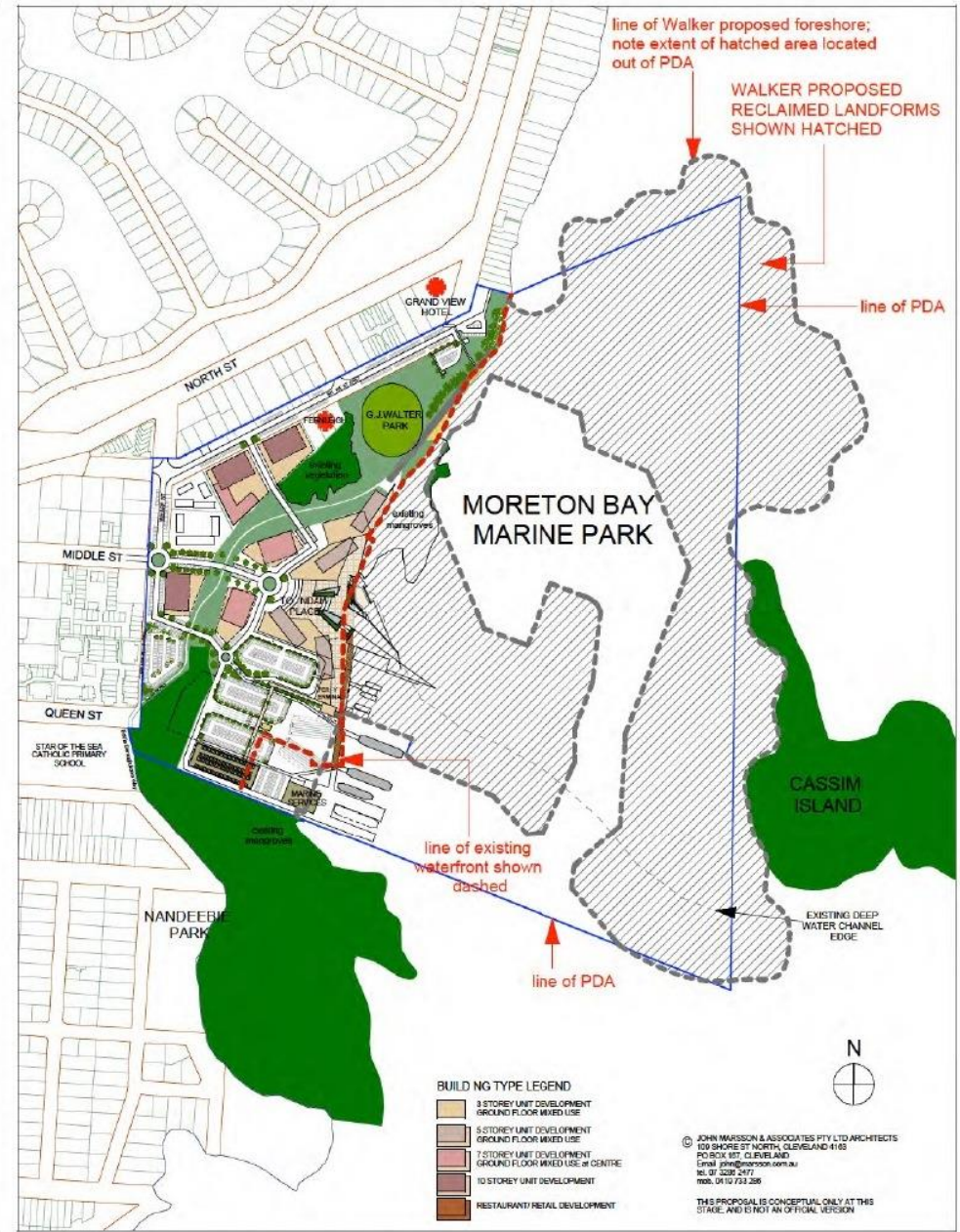

WALKER GROUP DEVELOPMENT PROPOSAL
-DESCRIPTIVE COMMENTS OVERLAID

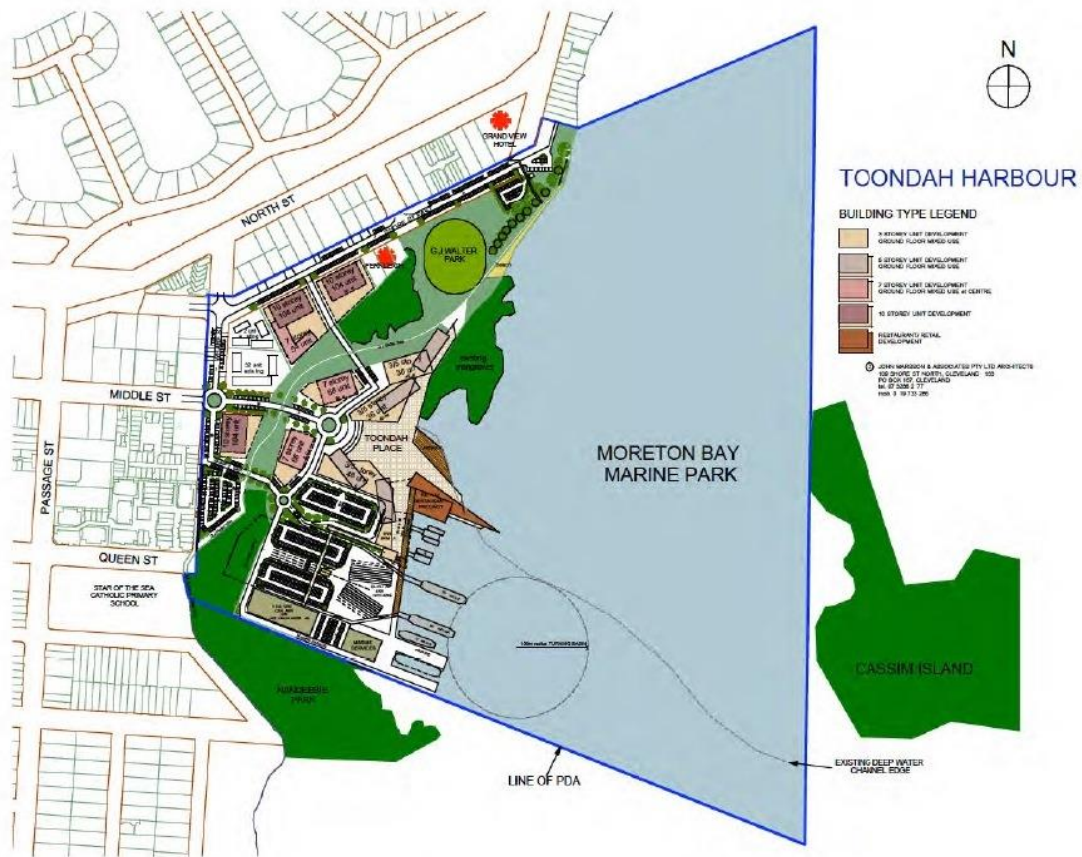

ALTERNATIVE CONCEPT PROPOSAL
AVOIDING MAJOR INTRUSION INTO MARINE PARK



TOONDAH HARBOUR

This proposal is conceptual only at this stage
and is not an official version

© John Marsson & Associates Pty Ltd Architects

